

455 Series Regulator

*Single Stage
Electroless
Nickel-plated
Forged Brass Body
Corrosive Service*



455-2332 shown

The 455 Series regulators are intended for primary pressure control of highly corrosive gases such as chlorides, sulfides and other acid-forming gases.

Deep Purge

For safety and corrosion prevention, CONCOA highly recommends the addition of a Deep Purge assembly to the 455 Series regulator. Completely purging a system prevents the release of hazardous gases into the work place. In addition, the Deep Purge prevents the introduction of moisture to the regulator which forms acids in the body and results in corrosion.

Typical Applications

- Hydrogen chloride
- Chlorine
- Boron trichloride
- Hydrogen bromide
- Hydrogen sulfide
- Dichlorosilane

400 Advantage

- *Nickel-plated forged brass body*
Durable, long-lasting construction
- *Convolute 316L stainless steel diaphragm*
Sensitive to downstream changes
- *Capsule® seat*
Serviceability and long life
- *Captured vent standard*
Safely vent exhaust gases
- *Hastelloy® seat assembly*
Superior corrosion resistance
- *High-load marginal spring*
Positive seat closure

Materials

Body
Electroless nickel-plated forged brass

Bonnet
Electroless nickel-plated forged brass

Seat
PTFE

Nozzle
Hastelloy®

Diaphragm
316L stainless steel

Diaphragm Seal
PTFE

Specifications

Maximum Inlet Pressure
3000 PSIG (210 BAR)

Temperature Range
-40°F to 140°F (-40°C to 60°C)

Gauges
2½" diameter Monel®

Ports
¼" FPT

Helium Leak Integrity
1 x 10⁻⁸ scc/sec

Cv
0.2

Weight (455-2332-660)
7.23 lbs. (3.28 kg)

Flow Performance Curves

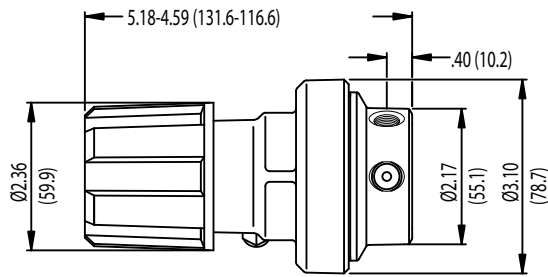
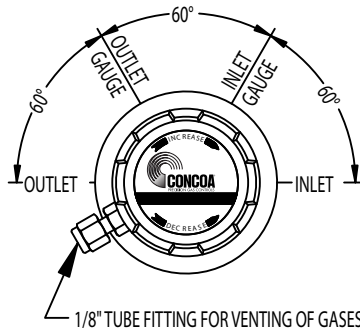
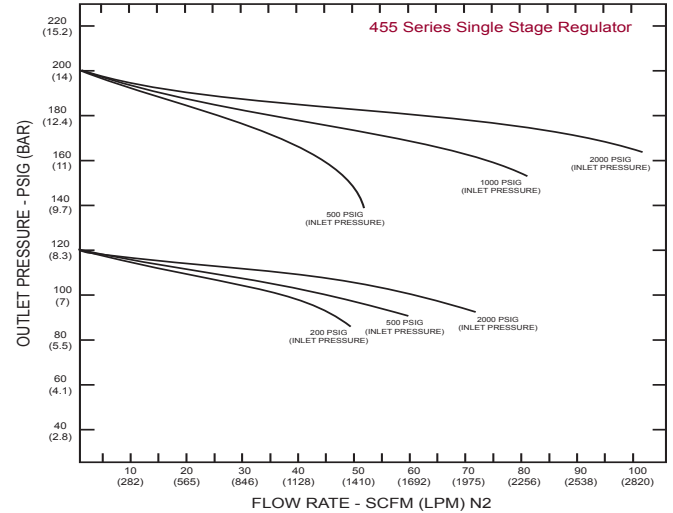
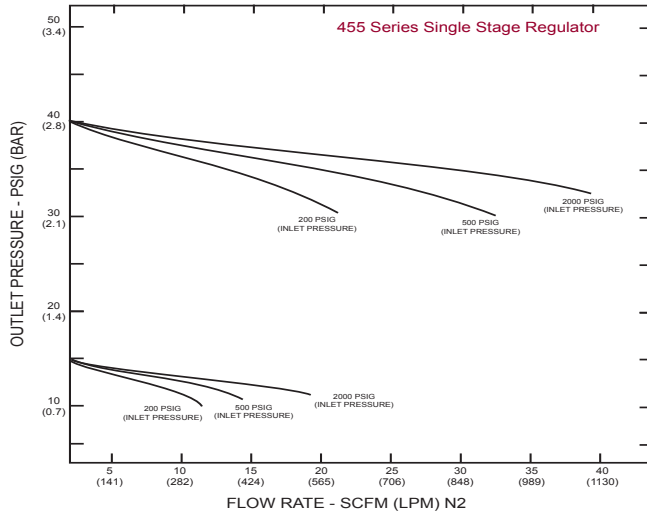

400 Series Nickel Plated Regulators

Ordering Information *(For information about how to use this table please see page 4.)*

455	A	B	C	D	-Inlet	Options	
Series 455	Outlet Pressure 1: 0-15 2: 0-40 3: 0-120 4: 0-200 5: 0-250	Outlet Gauge 30"-0-30 PSIG 0-60 PSIG 0-200 PSIG 0-400 PSIG 0-400 PSIG	Inlet Gauge 0: None 3: 0-4000 PSIG 5: 0-1000 PSIG 6: 0-300 PSIG 7: 0-400 PSIG 8: 0-200 PSIG	Outlet Assemblies 0: 1/4" FPT Port 1: 1/4" MPT 2: 1/4" Tube Fitting 3: Diaphragm Valve 1/4" Tube Fitting 4: Diaphragm Valve 1/4" MPT 5: Needle Valve 1/4" MPT 6: 1/8" Tube Fitting 7: 3/8" Tube Fitting 8: Diaphragm Valve 1/8" Tube Fitting 9: Diaphragm Valve 1/4" FPT M: 6mm Tube Fitting S: Diaphragm Valve 6mm Tube Fitting	Assembly/ Gauges 0: Bare Body 1: Standard Assembly (PSIG/kPa Gauge) without Deep Purge 2: Standard Assembly (PSIG/kPa Gauge) with Deep Purge 4: Standard Assembly (PSIG/BAR Gauge) without Deep Purge 5: Standard Assembly (PSIG/BAR Gauge) with Deep Purge	Inlet Connections 000: 1/4" FPT TF2: 1/8" Tube TF4: 1/4" Tube TF6: 3/8" Tube M06: 6mm Tube CGA DIN 477 BS 341 and others available	None
Related Options		• Passivation for Fluorine Service					