

453 Series Regulator

316L Stainless Steel Steam-Heated Vaporizing Regulator

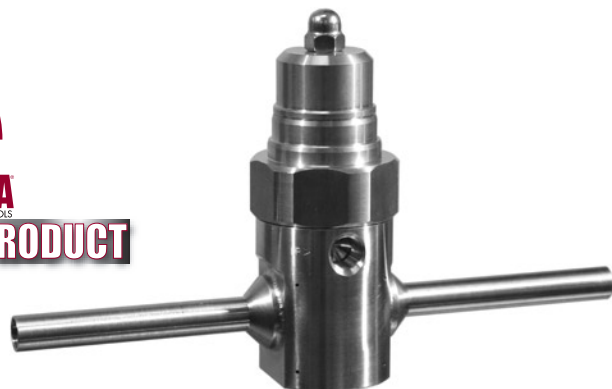

453-0000 shown

The 453 Series Steam-heated vaporizing regulator is designed to heat and vaporize an inlet gas stream containing heavy hydrocarbons so that they will remain in the vapor state for chromatographic analysis. The unique heat exchanger portion of the regulator is designed to maximize contact with the media steam for highly efficient heat transfer. The durable design, capsule seat, and six outlet pressure ranges allow the 453 Series regulators to meet the needs of diverse applications.

Advanced Features

- *316L stainless steel barstock body*
- *Pressure ranges available:
0 - 15 to 0 - 500 PSIG*
Wide variety of applications
- *Metal to metal seals*
No possibility of gas contamination
- *Capsule Seat*
Increased serviceability and life
- *Internal heat exchanger*
Improved heat transfer
- *Temperature rating to 550°F (288°C)*
High level of heating capability

400 Advantage

Materials

Specifications

<ul style="list-style-type: none"> • <i>Metal-to-metal diaphragm seal</i> No possibility of gas contamination • <i>Capsule® seat</i> Increased serviceability and life • <i>316L stainless steel diaphragm</i> No inboard diffusion • <i>Orientable captured vent capable</i> Safety in any installation • <i>Low wetted surface area</i> Minimal purge requirements • <i>10-micron sintered wire mesh inlet filter</i> Protects seat from being damaged by particulate 	<p><i>Body</i> 316L stainless steel barstock</p> <p><i>Bonnet</i> 316L stainless steel barstock</p> <p><i>Seat</i> Arlon® (PEEK)</p> <p><i>Diaphragm</i> 316L stainless steel</p> <p><i>Heat Exchanger</i> 316L stainless steel barstock</p>	<p><i>Maximum Inlet Pressure</i> 3000 PSIG (210 BAR)</p> <p><i>Maximum Temperature</i> 550°F (288°C)</p> <p><i>Maximum Flow (100 PSIG)</i> 600 SCFH (283 LPM)</p> <p><i>Inlet Connection</i> 1/8" FPT</p> <p><i>Outlet Connection</i> 1/4" FPT</p> <p><i>Steam Tubing</i> 1/2" O.D. x .049 wall thickness</p> <p><i>Helium Leak Integrity</i> 1 x 10⁻⁹ scc/sec</p> <p><i>Weight</i> 3.5lbs. (1.59 kg)</p>
---	--	--

Flow Performance Curves

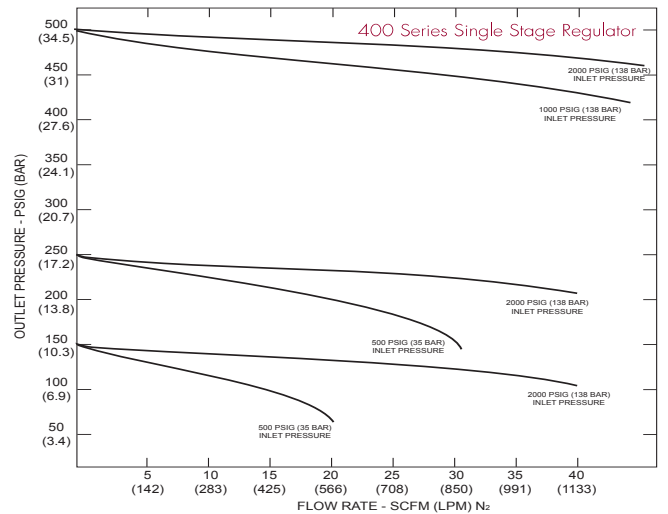
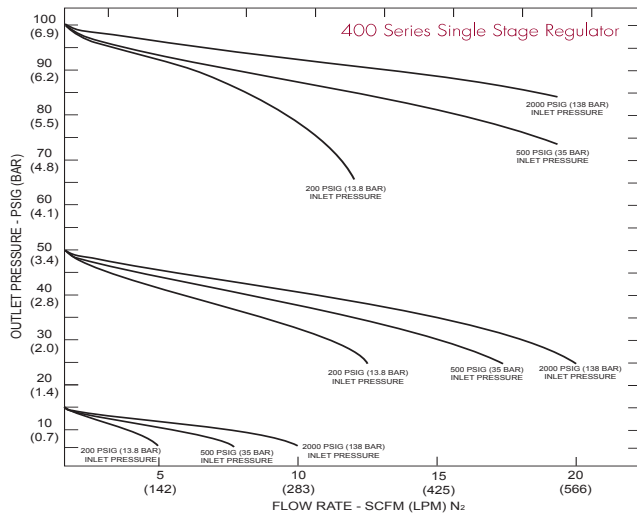

400 Series High Temp. & Vaporizing Regulators

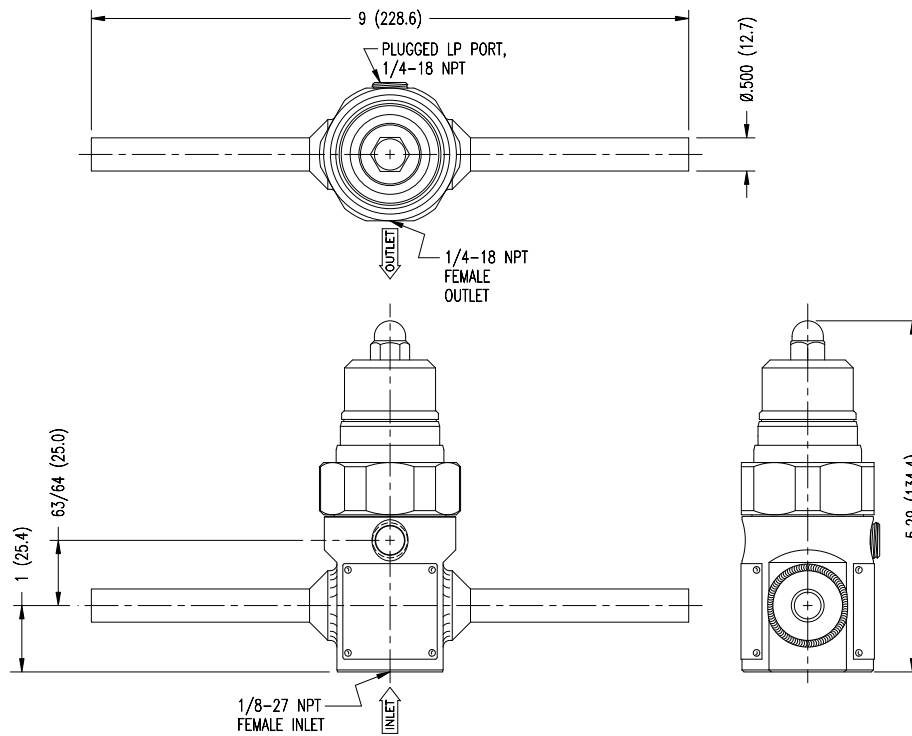

Ordering Information *(For information about how to use this table please see page 4.)*

453	A	B	C	D	-Inlet
Series 453	Max Delivery Pressure	0	Outlet Connection	0	Connections
	1: 15 PSIG		0: 1/4" FPT		000: 1/8" FPT
	2: 50 PSIG		1: 1/8" Tube Fitting		TF2: 1/8" Tube
	3: 100 PSIG		2: 1/4" Tube Fitting		TF4: 1/4" Tube
	4: 250 PSIG		3: 3/8" Tube Fitting		TF6: 3/8" Tube
	5: 500 PSIG		M: 6mm Tube Fitting		M06: 6mm Tub
	7: 150 PSIG				