

# 325 Series Regulator

CRN OH 5216.5C

*Single Stage  
Chrome-Plated  
Brass Barstock Body  
316L Stainless Steel  
Diaphragm  
Lecture Bottle  
Regulator*



325-3351 shown

The 325 Series regulators are specifically designed for use with non-corrosive gases in lecture bottles. The incorporation of our smallest Capsule® allows excellent pressure regulation over the useful pressure range of a lecture bottle.

## Typical Applications

- University classrooms
- University laboratories
- Chemical research
- Pharmaceutical manufacturing

## Advanced Features

- Chrome-plated brass barstock body  
Smooth surface finish
- Low droop  
Stable outlet pressure
- 1½" pressure gauges  
Small envelope

## 300 Advantage

## Materials

## Specifications

- *Capsule® seat*  
Increased serviceability and life
- *316L stainless steel diaphragm*  
No inboard diffusion
- *Low wetted surface area*  
Minimal purge requirements
- *Field-adjustable pressure limit*  
Safeguard downstream equipment
- *Convuluted diaphragm*  
Smooth pressure changes
- *Compact design*  
Easily transported and integrated

*Body*  
Chrome-plated brass barstock

*Bonnet*  
Chrome-plated die cast zinc

*Seat*  
PTFE

*Filter*  
10 micron sintered bronze

*Diaphragm*  
316L stainless steel

*Internal Seals*  
PTFE

*Maximum Inlet Pressure*  
3000 PSIG (210 BAR)

*Temperature Range*  
-40°F to 140°F (-40°C to 60°C)

*Gauges*  
1½" diameter chrome-plated brass

*Ports*  
⅛" FPT (¼" FPT relief valve)

*Helium Leak Integrity*  
1 x 10<sup>-8</sup> scc/sec

*Cv*  
0.02

*Weight (325-3351-180)*  
2.0 lbs. (0.89 kg)

# Flow Performance Curves

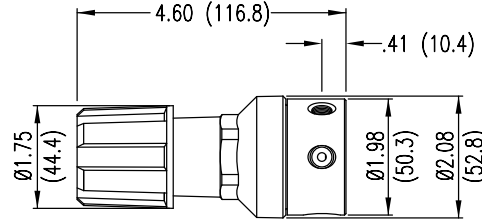
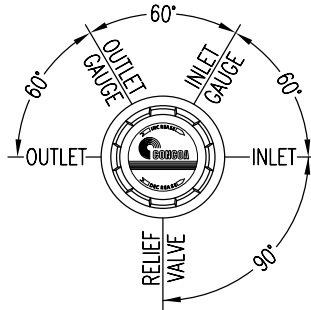
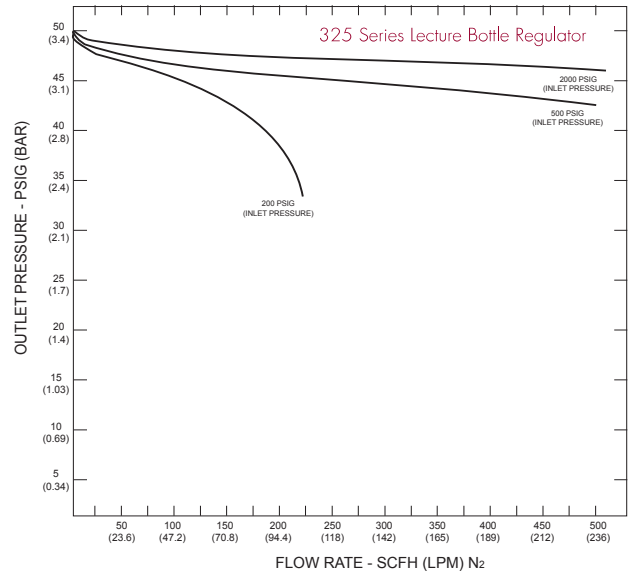
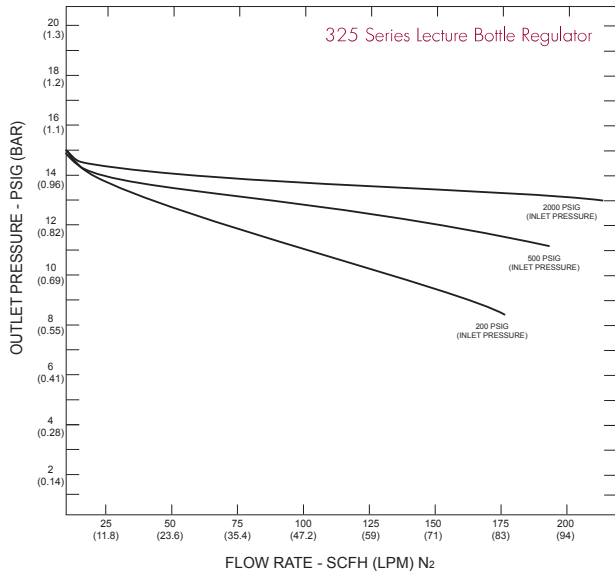

## Ordering Information *(For information about how to use this table please see page 4.)*

325	A	B	C	D	-Inlet	Options	
Series 325	Outlet Pressure 1: 0-15 3: 0-50	Outlet Gauge 0-30 PSIG 0-100 PSIG	Inlet Gauge 0: None 3: 0-4000 PSIG	Outlet Assemblies 0: 1/8" FPT Port 1: 1/4" MPT 5: Needle Valve 1/8" MPT	Assembly/ Gauges 0: Bare Body 1: Standard Assembly	Connections 000: 1/8" FPT CGA 110 CGA 170 CGA 180	Installed Options None

300 Series Lecture Bottle Regulators