

302 Series Regulator

CRN OH 5216.5C

Single Stage
Chrome-Plated
Brass Barstock Body
Four-Port
Configuration
316L Stainless Steel
Diaphragm



302-2331 shown

The 302 Series regulators are intended for primary pressure control of non-corrosive, high purity or liquefied gases or for applications where minor fluctuations in outlet pressure due to diminishing inlet supply can be tolerated.

Typical Applications

- Gas and liquid chromatography
- High purity carrier gases
- Zero, span and calibration gases
- High purity chamber pressurization
- Liquefied hydrocarbon gas control
- Control of cryogenic gases

Advanced Features

- Chrome-plated brass barstock body
Smooth surface finish
- Rear panel-mountable
Easy installation
- Pressure ranges 0-15 to 0-500 PSIG
Broad range of applications

300 Advantage

Materials

Specifications

- *Capsule® seat*
Increased serviceability and life
- *316L stainless steel diaphragm*
No inboard diffusion
- *Low wetted surface area*
Minimal purge requirements
- *Field-adjustable pressure limit*
Safeguard downstream equipment
- *Convuluted diaphragm*
Smooth pressure changes
- *Compact design*
Easily transported and integrated

Body
Chrome-plated brass barstock

Bonnet
Chrome-plated die cast zinc

Seat
PTFE
PCTFE with 4500 PSIG inlet option

Filter
10 micron sintered bronze

Diaphragm
316L stainless steel

Internal Seals
PTFE

Maximum Inlet Pressure
3000 PSIG (210 BAR)
4500 PSIG (310 BAR) optional

Temperature Range
-40°F to 140°F (-40°C to 60°C)

Gauges
2" diameter chrome-plated

Ports
¼" FPT

Helium Leak Integrity
1 x 10⁻⁸ scc/sec

Cv
0.1

Weight (302-2331-580)
3.1 lbs. (1.40 kg)

Flow Performance Curves

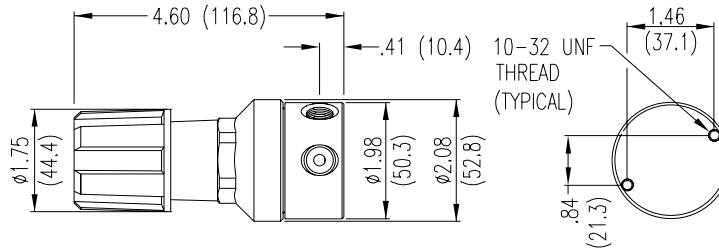
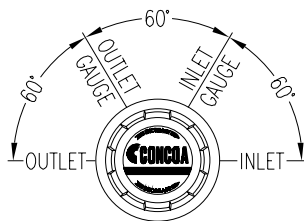
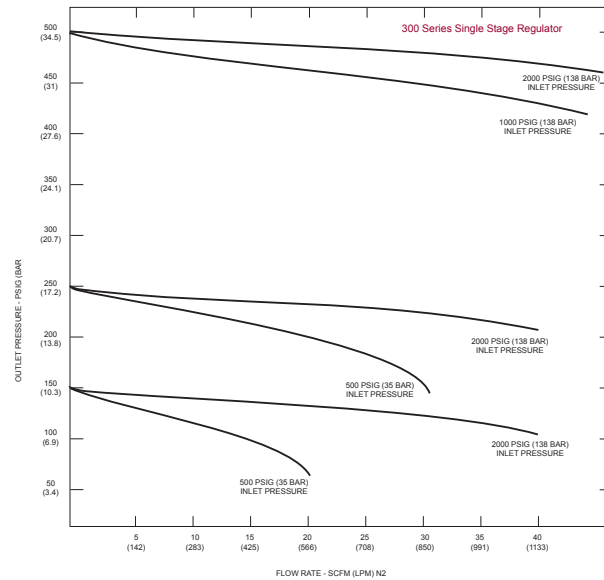
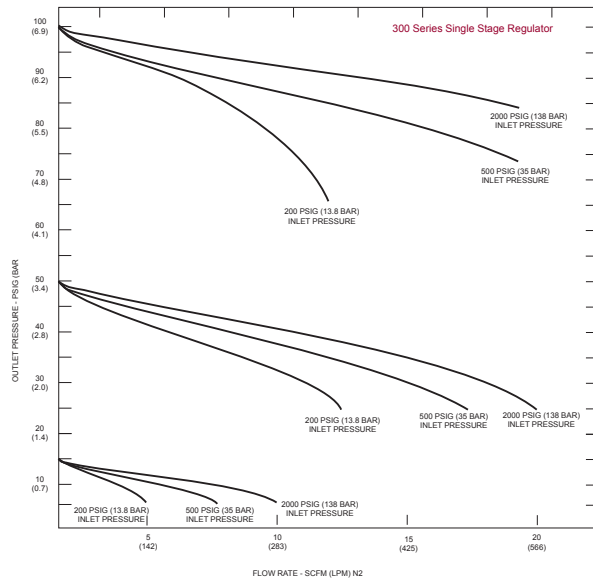

Ordering Information *(For information about how to use this table please see page 4.)*

302	A	B	C	D	-Inlet	Options	
Series 302	Outlet Pressure 1: 0-15* 2: 0-50 3: 0-100 4: 0-250 5: 0-500 7: 0-150 <i>*Not available with 4500 PSIG maximum inlet pressure</i>	Outlet Gauge 30"-0-30 PSIG 30"-0-100 PSIG 30"-0-200 PSIG 0-400 PSIG 0-1000 PSIG 30"-0-200 PSIG <i>*Maximum inlet pressure 4500 PSIG (310 BAR) with PCTFE Seat Capsule</i>	Inlet Gauge 0: None 3: 0-4000 PSIG 5: 0-1000 PSIG 6: 0-300 PSIG 7: 0-400 PSIG 8: 0-6000 PSIG* <i>*Maximum inlet pressure 4500 PSIG (310 BAR) with PCTFE Seat Capsule</i>	Outlet Assemblies 0: 1/4" FPT Port 1: 1/4" MPT 2: 1/4" Tube Fitting 3: Diaphragm Valve 1/4" Tube Fitting 4: Diaphragm Valve 1/4" MPT 5: Needle Valve 1/4" MPT 6: 1/8" Tube Fitting 7: 3/8" Tube Fitting 8: Diaphragm Valve 1/8" Tube Fitting 9: Diaphragm Valve 1/4" FPT A: 3/8" BSP Right Hand Fitting M: 6mm Tube Fitting S: Diaphragm Valve 6mm Tube Fitting	Assembly/ Gauges 0: Bare Body 1: Standard Assembly (PSIG/kPa Gauges) 2: Standard Assembly (BAR/PSIG Gauges)	Inlet Connections 000: 1/4" FPT TF2: 1/8" Tube TF4: 1/4" Tube TF6: 3/8" Tube M06: 6mm Tube CGA DIN 477 BS 341 and others available	Installed Options A: Protocol Alarm Station (110V) B: Protocol Alarm Station (220V) C: Protocol Switchover Station G: Protocol Switchover Station with Alarm (110V) H: Protocol Switchover Station with Alarm (220V) M: Protocol Station T: Tee Purge* <i>*Not available with 4500 PSIG max inlet pressure</i>

300 Series Regulators