

# 212 Series Regulator

CRN OH 5216.5C

*Dual Stage  
Chrome-Plated  
Forged Brass Body  
Five-Port  
Configuration*



212-2331 shown

*316L Stainless Steel  
Diaphragm*

The 212 Series regulators are intended for primary pressure control of non-corrosive, high purity or liquefied gases (up to grade 4.5) for applications requiring constant pressure control and delivery regardless of supply pressure variations.

## Typical Applications

- Gas supply purging
- Gas system charging
- Fuel gas supply control
- Calibration gas control

## Advanced Features

- Chrome-plated forged brass body  
Economical high purity design
- High flow capacity  
Supply multiple user locations
- Pressure ranges 0-15 to 0-200 PSIG  
Broad range of applications
- 3000 PSIG inlet pressure rating  
Safe use with high pressure cylinders

## 200 Advantage

- *Capsule® seat*  
Increased serviceability and life
- *316L stainless steel diaphragm*  
No inboard diffusion
- *Forged body*  
Durable, long-lasting construction
- *Field-adjustable pressure limit*  
Safeguard downstream equipment
- *Large convoluted diaphragm*  
Smooth pressure changes
- *Standard relief valve*  
Diaphragm and gauge protection

## Materials

*Body*  
Chrome-plated forged brass

*Bonnet*  
Chrome-plated die cast zinc

*Seat*  
PTFE

*Filter*  
10 micron sintered bronze

*Diaphragm*  
316L stainless steel

*Internal Seals*  
PTFE

## Specifications

*Maximum Inlet Pressure*  
3000 PSIG (210 BAR)

*Temperature Range*  
-40°F to 140°F (-40°C to 60°C)

*Gauges*  
2½" diameter chrome-plated brass

*Ports*  
¼" FPT

*Helium Leak Integrity*  
1 x 10<sup>-8</sup> scc/sec

*Cv*  
0.28

*Weight (212-3331-580)*  
5.1 lbs. (2.3 kg)

# Flow Performance Curves

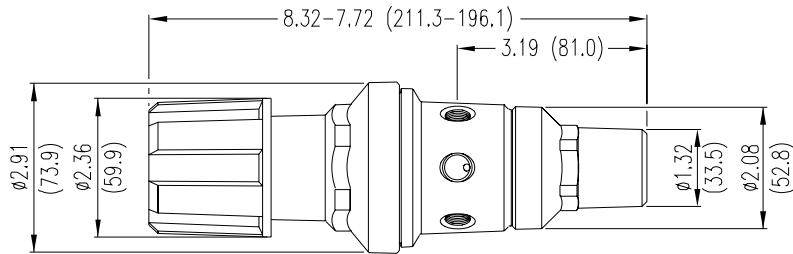
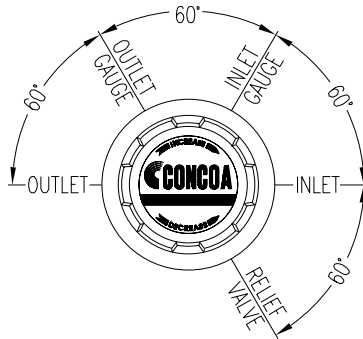
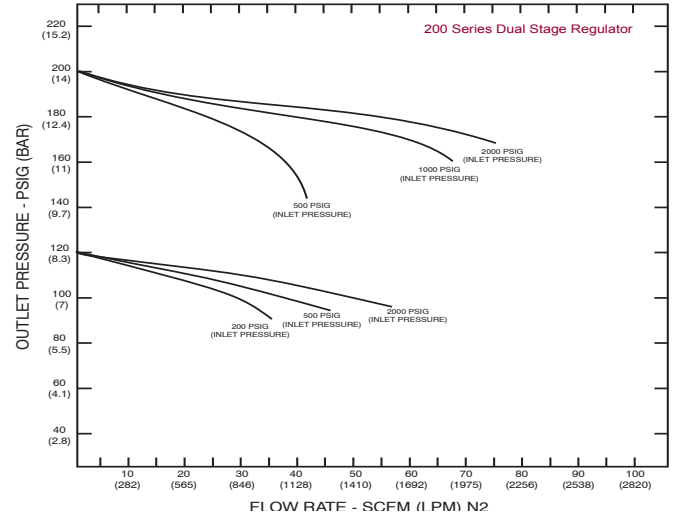
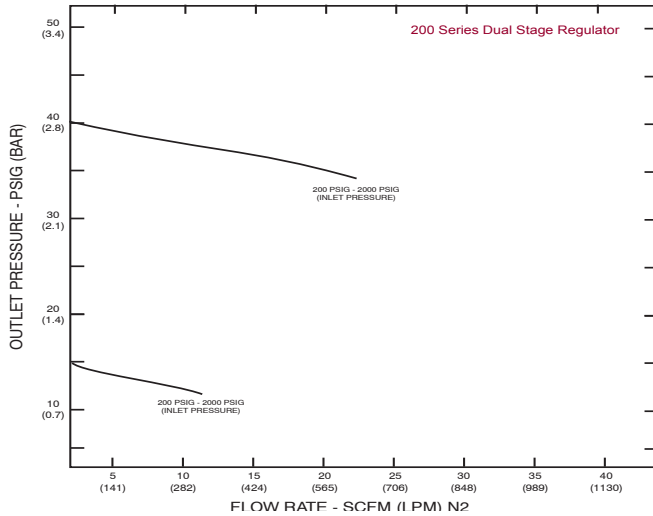

## Ordering Information *(For information about how to use this table please see page 4.)*

212	A	B	C	D	-Inlet	Options	
Series 212	Outlet Pressure 1: 0-15 2: 0-40 3: 0-120 4: 0-200 5: 0-15	Outlet Gauge 0-30 PSIG 0-60 PSIG 0-200 PSIG 0-400 PSIG 0-30 PSIG with redline for acetylene use	Inlet Gauge 0: None 3: 0-4000 PSIG 5: 0-1000 PSIG 6: 0-400 PSIG 9: 0-600 PSIG	Outlet Assemblies 0: ¼" FPT Port 1: ¼" MPT 2: ¼" Tube Fitting 3: Diaphragm Valve ¼" Tube Fitting 4: Diaphragm Valve ¼" MPT 5: Needle Valve ¼" MPT 6: ⅛" Tube Fitting 7: ⅜" Tube Fitting 8: Diaphragm Valve ⅛" Tube Fitting 9: Diaphragm Valve ¼" FPT A: ⅜" BSP Right Hand Fitting B: Diaphragm Valve ⅜" Tube Fitting M: 6mm Tube Fitting S: Diaphragm Valve 6mm Tube Fitting	Assembly/ Gauges 0: Bare Body 1: Standard Assembly (PSIG/kPa Gauges) 2: Standard Assembly (BAR/PSIG Gauges)	Inlet Connections 000: ¼" FPT TF2: ⅛" Tube TF4: ¼" Tube TF6: ⅜" Tube M06: 6mm Tube  CGA DIN 477 BS 341 and others available	Installed Options A: Protocol Alarm Station (110V) B: Protocol Alarm Station (220V) C: Protocol Switchover Station G: Protocol Switchover Station with Alarm (110V) H: Protocol Switchover Station with Alarm (220V) M: Protocol Station T: Tee Purge

200 Series Regulators