

# 206 Series Regulator

CRN OH 5216.5C

*Single Stage*  
*Chrome-Plated*  
*Forged Brass Body*  
*316L Stainless Steel*  
*Diaphragm*  
*Liquid Cylinder*  
*Regulator*  
*Four Port*  
*Configuration*

## Typical Applications

- Argon
- Nitrogen
- Oxygen
- Carbon Dioxide
- Certain Freons

## Advanced Features

- *Designed for low inlet pressures*  
Optimized flow with liquid cylinders
- *Large Capsule® seat*  
Permits flow rates unobtainable with conventional regulators
- *3000 PSIG inlet pressure rating*  
Safe use on high pressure cylinders



206-3021 shown

The 206 Series regulators are intended for primary pressure control of gases supplied from cryogenic liquid cylinders.

## 200 Advantage Materials Specifications

<ul style="list-style-type: none"><li>• <i>Capsule® seat</i> Increased serviceability and life</li><li>• <i>316L stainless steel diaphragm</i> No inboard diffusion</li><li>• <i>Forged body</i> Durable, long-lasting construction</li><li>• <i>Field-adjustable pressure limit</i> Safeguard downstream equipment</li><li>• <i>Large convoluted diaphragm</i> Smooth pressure changes</li><li>• <i>Standard relief valve</i> Diaphragm and gauge protection</li></ul>	<p><i>Body</i> Chrome-plated forged brass</p> <p><i>Bonnet</i> Chrome-plated die cast zinc</p> <p><i>Seat</i> PTFE</p> <p><i>Filter</i> 10 micron sintered bronze</p> <p><i>Diaphragm</i> 316L stainless steel</p> <p><i>Internal Seals</i> PTFE</p>	<p><i>Maximum Inlet Pressure</i> 3000 PSIG (210 BAR)</p> <p><i>Temperature Range</i> -40°F to 140°F (-40°C to 60°C)</p> <p><i>Gauge</i> 2½" diameter chrome-plated brass</p> <p><i>Ports</i> ¼" FPT</p> <p><i>Helium Leak Integrity</i> 1 x 10<sup>-8</sup> scc/sec</p> <p><i>Cv</i> 0.28</p> <p><i>Weight (206-3031-580)</i> 3.5 lbs. (1.59 kg)</p>
---	--	--

Controls Corporation of America, Inc.

1501 Harpers Road • Virginia Beach, Virginia 23454 USA • 1.800.225.0473 • 757.422.3125 • www.concoa.com

# Flow Performance Curves

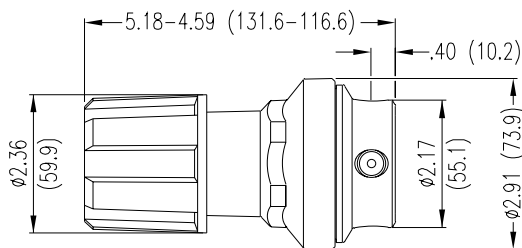
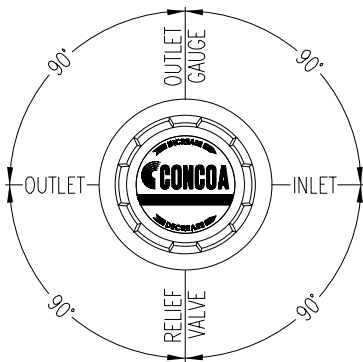
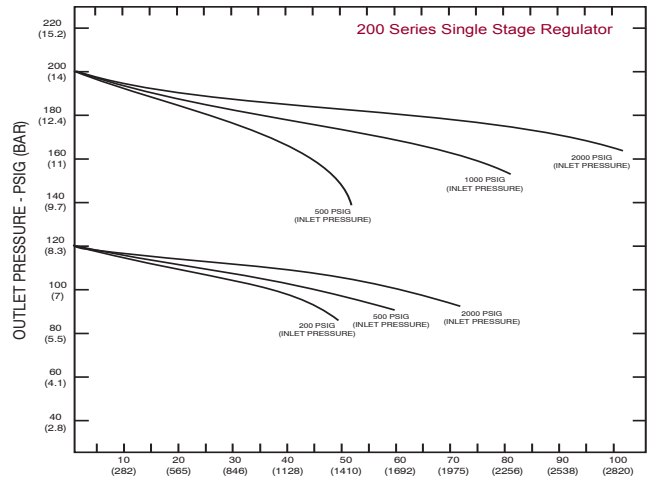
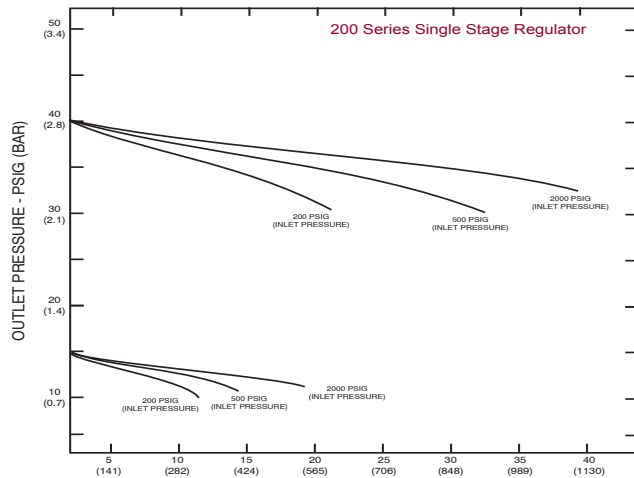

## Ordering Information *(For information about how to use this table please see page 4.)*

206	A		B	C	D	-Inlet	Options
Series 206	Outlet Pressure	Outlet Gauge	Inlet Gauge	Outlet Assemblies	Assembly/ Gauges	Inlet Connections	Installed Options
	1: 0-15	0-30 PSIG	0: None	0: 1/4" FPT Port	0: Bare Body	000: 1/4" FPT	A: Protocol Alarm Station (110V)
	2: 0-40	0-60 PSIG		1: 1/4" MPT	1: Standard Assembly (PSIG/kPa Gauge)	TF2: 1/8" Tube	B: Protocol Alarm Station (220V)
	3: 0-120	0-200 PSIG		2: 1/4" Tube Fitting	2: Standard Assembly (BAR/PSIG Gauge)	TF4: 1/4" Tube	C: Protocol Switchover Station
	4: 0-200	0-400 PSIG		3: Diaphragm Valve 1/4" Tube Fitting		TF6: 3/8" Tube	G: Protocol Switchover Station with Alarm (110V)
				4: Diaphragm Valve 1/4" MPT		M06: 6mm Tube	H: Protocol Switchover Station with Alarm (220V)
				5: Needle Valve 1/4" MPT		CGA	
				6: 1/8" Tube Fitting		DIN 477	
				7: 3/8" Tube Fitting		BS 341	
				8: Diaphragm Valve 1/8" Tube Fitting		and others available	
				9: Diaphragm Valve 1/4" FPT			
				A: 3/8" BSP Right Hand Fitting			
				B: Diaphragm Valve 3/8" Tube Fitting			
				M: 6mm Tube Fitting			
				S: Diaphragm Valve 6mm Tube Fitting			

200 Series Regulators