

205 Series Regulator

CRN OH 5216.5C

Single Stage Typical Applications

Chrome-Plated
Forged Brass Body

Four-Port
Configuration

316L Stainless Steel
Diaphragm

The 205 Series regulators are intended for secondary pressure control of non-corrosive, high purity or liquefied gases (up to grade 4.5) or as point of use pressure control in high purity gas distribution systems.

- Point of use laboratory systems
- Gas supply purging
- Liquefied hydrocarbon gas control
- Control of cryogenic gases
- Bulk gas distribution systems



205-3021 shown

Advanced Features

- Chrome-plated forged brass body
Economical high purity design
- High flow capacity
Supply multiple user locations
- Pressure ranges 0-15 to 0-200 PSIG
Broad range of applications
- 3000 PSIG inlet pressure rating
Safe use with high pressure cylinders

200 Advantage

Materials

Specifications

- *Capsule® seat*
Increased serviceability and life
- *316L stainless steel diaphragm*
No inboard diffusion
- *Forged body*
Durable, long-lasting construction
- *Field-adjustable pressure limit*
Safeguard downstream equipment
- *Large convoluted diaphragm*
Smooth pressure changes
- *Standard relief valve*
Diaphragm and gauge protection

Body
Chrome-plated forged brass

Bonnet
Chrome-plated die cast zinc

Seat
PTFE

Filter
10 micron sintered bronze

Diaphragm
316L stainless steel

Internal Seals
PTFE

Maximum Inlet Pressure
3000 PSIG (210 BAR)

Temperature Range
-40°F to 140°F (-40°C to 60°C)

Gauge
2½" diameter chrome-plated brass

Ports
¼" FPT

Helium Leak Integrity
1 x 10⁻⁸ scc/sec

Cv
0.28

Weight (205-3031-TF4)
3.2 lbs. (1.44 kg)

Controls Corporation of America, Inc.

1501 Harpers Road • Virginia Beach, Virginia 23454 USA • 1.800.225.0473 • 757.422.3125 • www.concoa.com

Flow Performance Curves

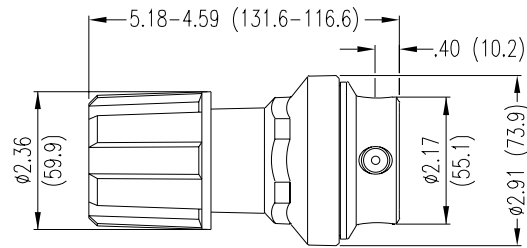
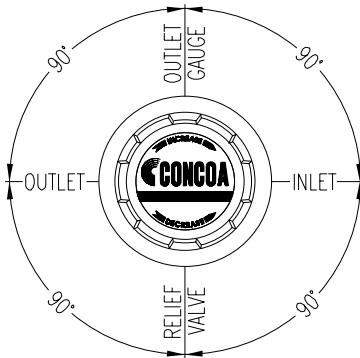
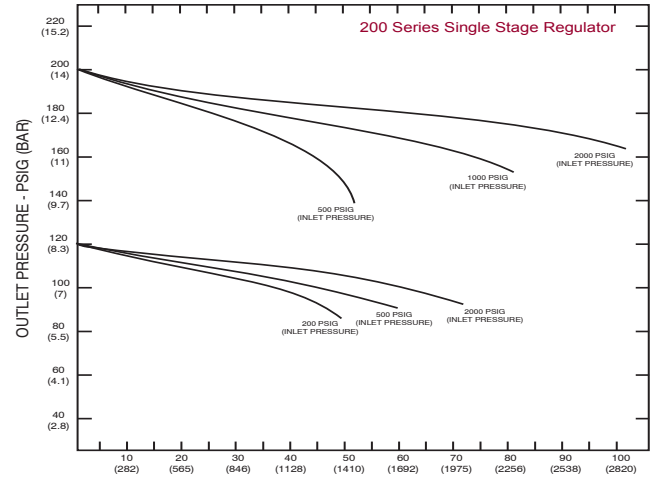
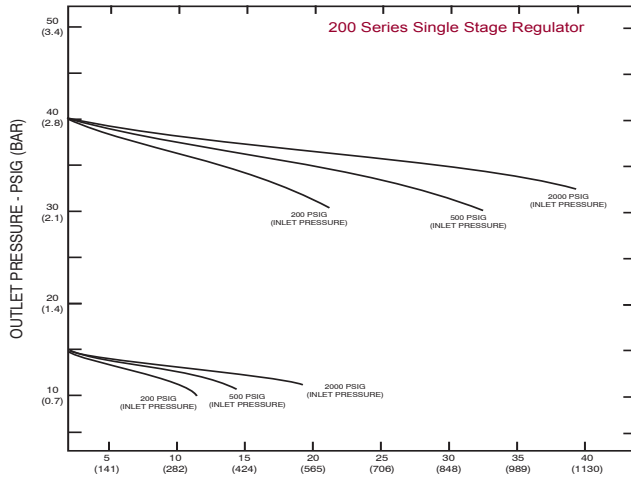

Ordering Information *(For information about how to use this table please see page 4.)*

205	A	B	C	D	-Inlet	Options	
Series 205	Outlet Pressure 1: 0-15 2: 0-40 3: 0-120 4: 0-200 5: 0-15 with redline for acetylene use	Outlet Gauge 0-30 PSIG 0-60 PSIG 0-200 PSIG 0-400 PSIG 0-30 PSIG	Inlet Gauge 0: None	Outlet Assemblies 0: 1/4" FPT Port 1: 1/4" MPT 2: 1/4" Tube Fitting 3: Diaphragm Valve 1/4" Tube Fitting 4: Diaphragm Valve 1/4" MPT 5: Needle Valve 1/4" MPT 6: 1/8" Tube Fitting 7: 3/8" Tube Fitting 8: Diaphragm Valve 1/8" Tube Fitting 9: Diaphragm Valve 1/4" FPT A: 3/8" BSP Right Hand Fitting B: Diaphragm Valve 3/8" Tube Fitting M: 6mm Tube Fitting S: Diaphragm Valve 6mm Tube Fitting	Assembly/ Gauges 0: Bare Body 1: Standard Assembly (PSIG/kPa Gauge) 2: Standard Assembly (BAR/PSIG Gauge) 6: Mirror Image Assembly (PSIG/kPa Gauges) 7: Mirror Image Assembly (BAR/PSIG Gauges)	Inlet Connections 000: 1/4" FPT TF2: 1/8" Tube TF4: 1/4" Tube TF6: 3/8" Tube M06: 6mm Tube CGA DIN 477 BS 341 and others available	Installed Options None

200 Series Regulators