

202 Series Regulator

CRN OH 5216.5C

Single Stage

*Chrome-Plated
Forged Brass Body*

*Five-Port
Configuration*

*316L Stainless Steel
Diaphragm*

The 202 Series regulators are intended for primary pressure control of non-corrosive, high purity or liquefied gases (up to grade 4.5) in applications where minor fluctuations in outlet pressure due to diminishing inlet supply pressure can be tolerated.



202-1331 shown

Typical Applications

- Gas supply purging
- Gas system charging
- Fuel gas supply control
- Calibration gas control
- Atomic absorption acetylene

Advanced Features

- Chrome-plated forged brass body
Economical high purity design
- High flow capacity
Supply multiple user locations
- Pressure ranges 0-15 to 0-200 PSIG
Broad range of applications

200 Advantage

- *Capsule® seat*
Increased serviceability and life
- *316L stainless steel diaphragm*
No inboard diffusion
- *Forged body*
Durable, long-lasting construction
- *Field-adjustable pressure limit*
Safeguard downstream equipment
- *Large convoluted diaphragm*
Smooth pressure changes
- *Standard relief valve*
Diaphragm and gauge protection

Materials

Body
Chrome-plated forged brass

Bonnet
Chrome-plated die cast zinc

Seat
PTFE
PCTFE with 4500 PSIG inlet option

Filter
10 micron sintered bronze

Diaphragm
316L stainless steel

Internal Seals
PTFE

Specifications

Maximum Inlet Pressure
3000 PSIG (210 BAR)

Temperature Range
-40°F to 140°F (-40°C to 60°C)

Gauges
2½" diameter chrome-plated brass

Ports
¼" FPT

Helium Leak Integrity
1 x 10⁻⁸ scc/sec

Cv
0.2

Weight (202-3331-580)
3.8 lbs. (1.74 kg)

Flow Performance Curves

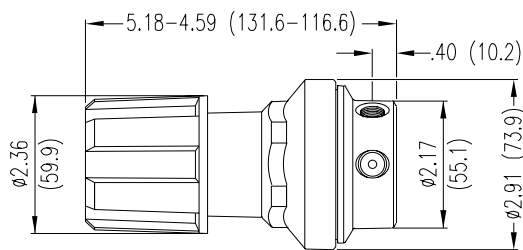
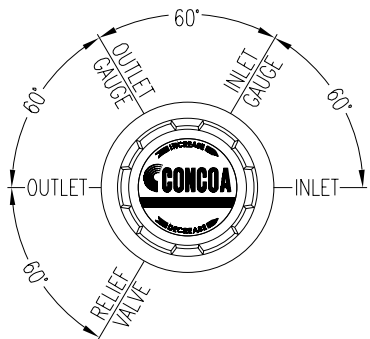
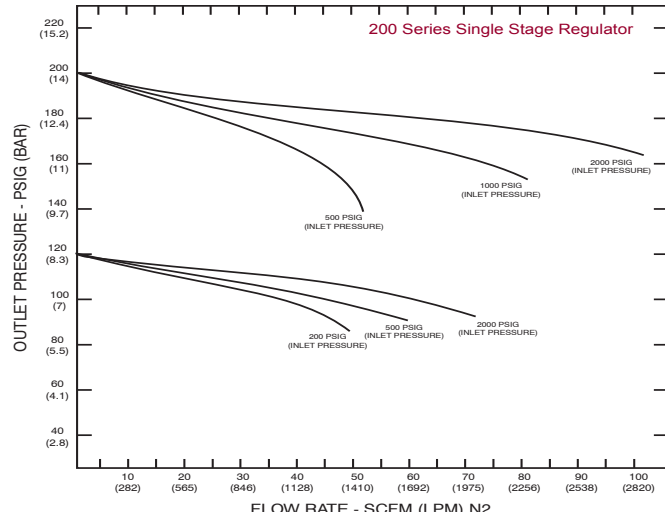
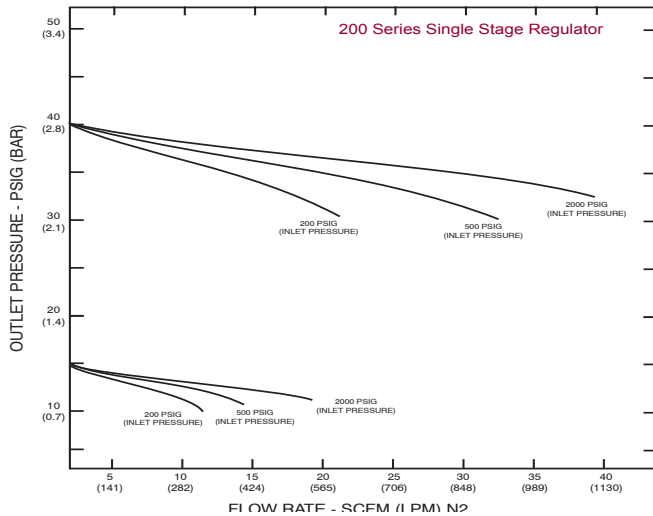

Ordering Information *(For information about how to use this table please see page 4.)*

202	A	B	C	D	-Inlet	Options	
Series 202	Outlet Pressure 1: 0-15 2: 0-40 3: 0-120 4: 0-200 5: 0-15* *With redline for acetylene use	Outlet Gauge 0-30 PSIG 0-60 PSIG 0-200 PSIG 0-400 PSIG 0-30 PSIG	Inlet Gauge 0: None 3: 0-4000 PSIG 5: 0-1000 PSIG 6: 0-400 PSIG 9: 0-600 PSIG	Outlet Assemblies 0: ¼" FPT Port 1: ¼" MPT 2: ¼" Tube Fitting 3: Diaphragm Valve ¼" Tube Fitting 4: Diaphragm Valve ¼" MPT 5: Needle Valve ¼" MPT 6: ⅛" Tube Fitting 7: ⅜" Tube Fitting 8: Diaphragm Valve ⅛" Tube Fitting 9: Diaphragm Valve ¼" FPT A: ⅜" BSP Right Hand Fitting B: Diaphragm Valve ⅜" Tube Fitting M: 6mm Tube Fitting S: Diaphragm Valve 6mm Tube Fitting	Assembly/ Gauges 0: Bare Body 1: Standard Assembly (PSIG/kPa Gauges) 2: Standard Assembly (BAR/PSIG Gauges)	Inlet Connections 000: ¼" FPT TF2: ⅛" Tube TF4: ¼" Tube TF6: ⅜" Tube M06: 6mm Tube CGA DIN 477 BS 341 and others available	Installed Options A: Protocol Alarm Station (110V) B: Protocol Alarm Station (220V) C: Protocol Switchover Station G: Protocol Switchover Station with Alarm (110V) H: Protocol Switchover Station with Alarm (220V) M: Protocol Station T: Tee Purge

200 Series Regulators